

Hazards of electric shock and burning. Installation, Commissioning and Maintenance to be done by qualified personnel only. Always use an appropriate voltage detection device to confirm the absence of voltage. Disconnect the power and isolate before proceeding with any work on this equipment. Use according to the operating instructions, professional practices, wiring rules, codes, safety regulations applicable to the installation.

### MECHANICAL INTERLOCK FITMENT

① REMOVE CUTOUTS AND ENSURE PIN ENGAGES IN BRIDGE

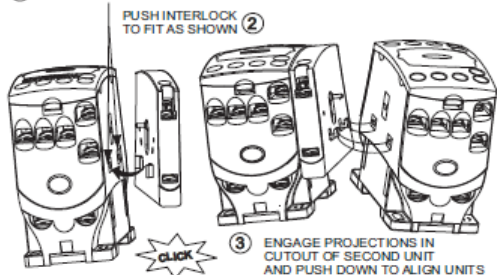

### DRILLING PLAN

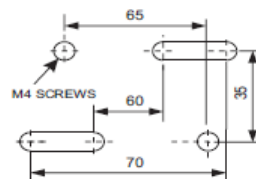

### COIL REPLACEMENT

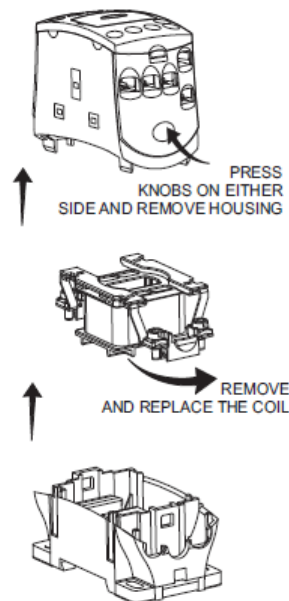

### ACCESSORIES

Description	Catalogue No.	Description	Catalogue No.
Mechanical Interlock Kit	CS945840000		
Auxiliary Contact Blocks			
Top 1NO - 1 Pole	CS945850000	Top 4NO - 4 Pole	CS945940000
Top 1NC - 1 Pole	CS945860000	Top 3NO+1NC - 4 Pole	CS945950000
Top 2NO - 2 Pole	CS945910000	Top 2NO+2NC - 4 Pole	CS945960000
Top 1NO+1NC - 2 Pole	CS945920000	Top 1NO+3NC - 4 Pole	CS945970000
Top 2NC - 2 Pole	CS945930000	Top 4NC - 4 Pole	CS945980000

### MAIN TERMINATIONS

Suitable for unprepared / lugless copper conductors  
 2 X 4 Sq. mm. Solid Conductors  
 2 X 2.5 Sq. mm. Stranded Conductors

Spares			
Description	Catalogue No.	Description	Catalogue No.
Spare Coil	CS94841*	MO 12 Contact Kit	CS948440000
MO 9 Contact Kit	CS948430000	MO 18 Contact Kit	CS948450000

\* Add 4 digit suffix for coil voltage and type of coil termination  
 Last Digit of Suffix "O" - Screw Type Termination  
 Last Digit of Suffix "T" - Fast-on Termination

### CONTACT REPLACEMENT

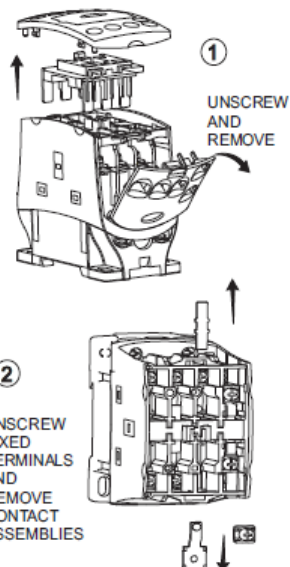

### TOP ADD-ON FITMENT

