

INSTRUCTION MANUAL

SURGE SUPPRESSOR - MO/MO C FR. 0/1/2/3 MO S1, MO S2, MO S3

ORDERING INFORMATION

CS91706G000	24V	SURGE SUPPRESSOR FOR MO/MO C FR.0/1 CONTACTORS-MO S1
CS91706J000	42-48V	
CS91706A000	110V	
CS91706B000	220-320V	SURGE SUPPRESSOR FOR MO/MO C FR.2 CONTACTORS-MO S2
CS91706D000	360-415V	
CS91707M000	525V	
CS91708G000	24V	SURGE SUPPRESSOR FOR MO/MO C FR.3 CONTACTORS-MO S3
CS91708J000	42-48V	
CS91708A000	110V	
CS91708B000	220-320V	
CS91708D000	360-415V	
CS91708M000	525V	

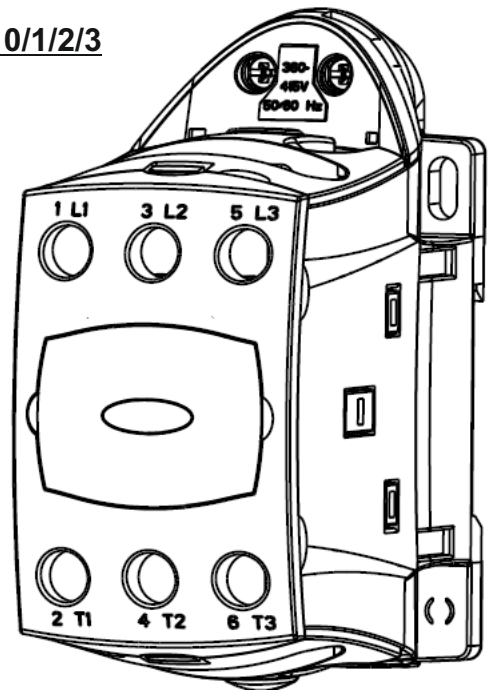
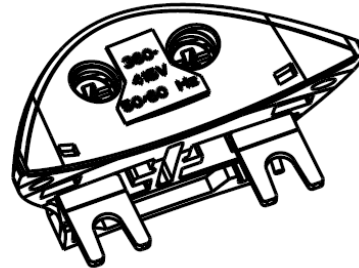
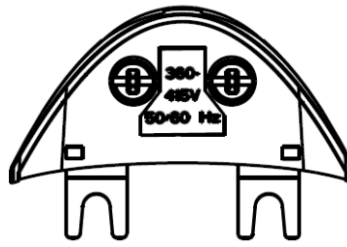

Hazards of electric shock and burning. Installation, Commissioning and Maintenance to be done by qualified personnel only. Always use an appropriate voltage detection device to confirm the absence of voltage. Disconnect the power and isolate before proceeding with any work on this equipment. Use according to the operating instructions, professional practices, wiring rules, codes, safety regulations applicable to the installation.

Carton, CFB sleeve can be recycled after removal of the brass staples from the carton.

L&T SWITCHGEAR
SAFE & SURE

OVERALL DIMENSIONS-MO/MO C FR.0/1 MO S1

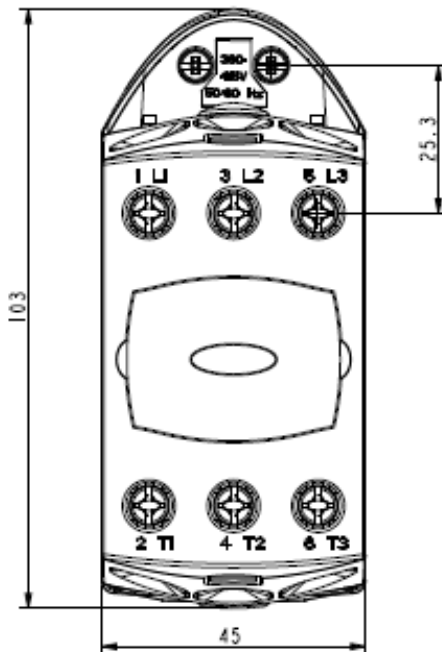
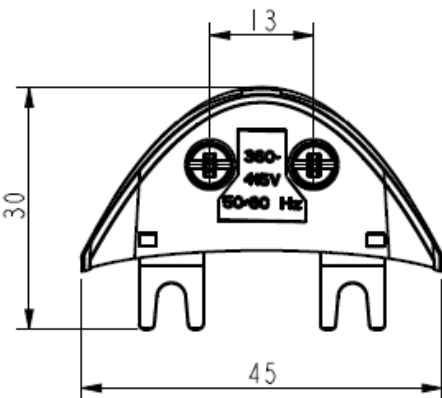

OVERALL DIMENSIONS-MO/MO C FR.2 MO S2

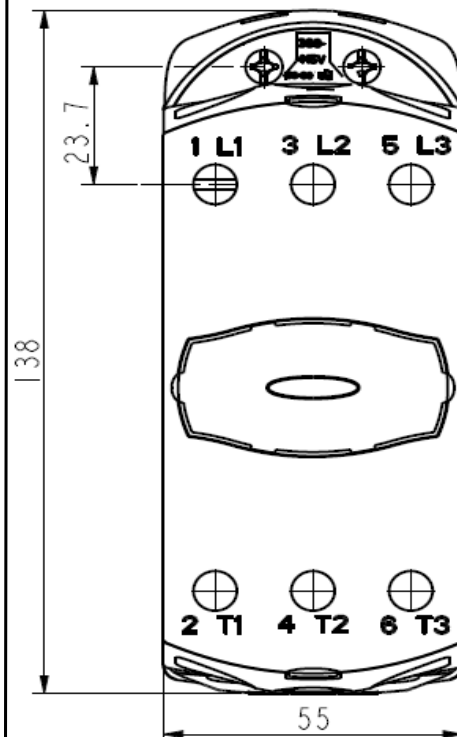
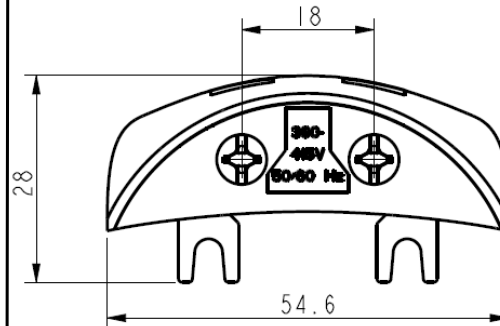

OVERALL DIMENSIONS-MO/MO C FR.3 MO S3

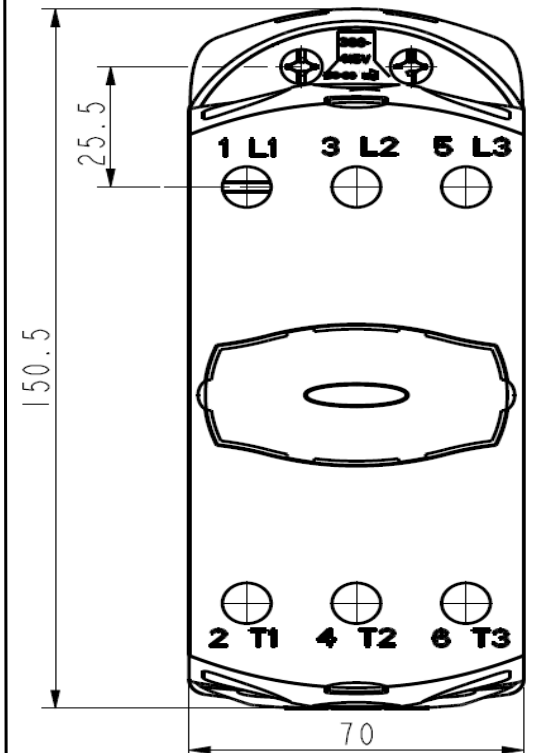
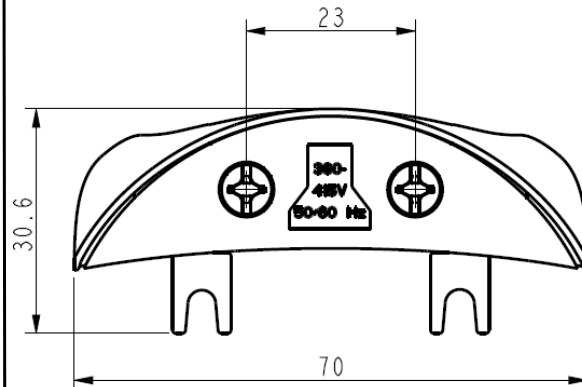

ASSEMBLY INSTRUCTIONS

1. Loosen the screw-washer assembly from the top side of contactor.(Side opposite to DIN rail mounting). Refer Fig. below

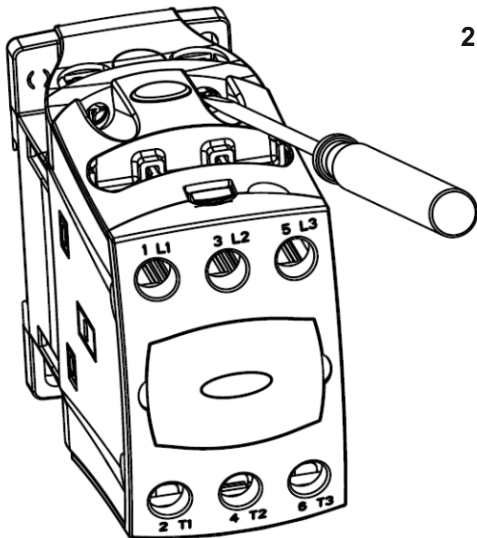

2. Assemble the surge suppressor on the coil terminal slots as shown below

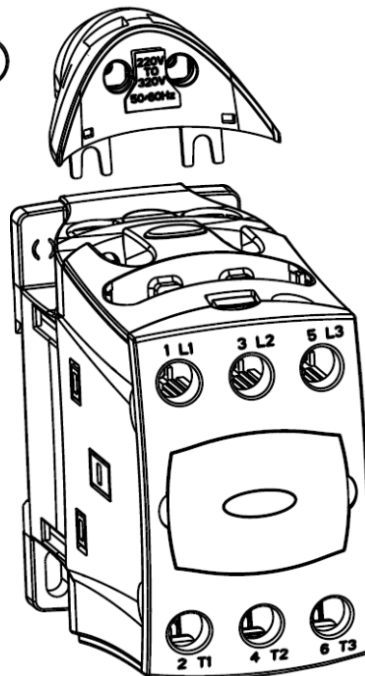

3. Tighten the surge suppressor assembly inside the coil terminal slot with the help of screw washer assembly

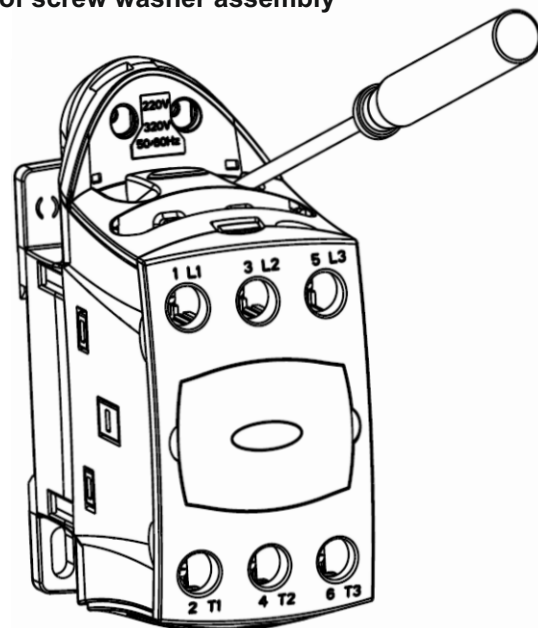

Tightening torque - Surge suppressor terminal to coil terminal of contactor:

For assembling MO S1 on MO/MO C Fr.0/1: 1.1Nm (Screw size: M3.5)

For assembling MO S2 on MO/MO C Fr.2: 1.1Nm (Screw size: M3.5)

For assembling MO S3 on MO/MO C Fr.3: 1.1Nm (Screw size: M3.5)

Tightening torque - Conductor to Surge suppressor terminal:

For assembling conductor on MO S1: 0.9Nm (Screw size: M3)

For assembling conductor on MO S2: 1.1Nm (Screw size: M3.5)

For assembling conductor on MO S3: 1.1Nm (Screw size: M3.5)



PRODUCT
INSTALLATION



DISCLAIMER
NOTES

“This literature gives information to user about product installation, operation maintenance and disposal. This information is not exhaustive and should customer require information, in specific cases, customer may contact customer interaction cell.”

“The manufacturer assumes no responsibility for injuries, losses, damages to human beings and/or equipments due to inappropriate application of instructions, provided herein.”

“Product development is a continuous process in L&T E&A. The information given in this literature is subject to change. For latest information the customer may contact customer interaction cell.”



CUSTOMER
CARE

CUSTOMER INTERACTION CELL (CIC)

BSNL / MTNL (Toll Free): 18002335858

RELIANCE (Toll Free): 1800 200 5858

Telephone: 022 6774 5858

email: cic@LNTEBG.com

website: www.LNTEBG.com

SDDC - SP03122

L&T SWITCHGEAR

SAFE & SURE

L&T Electrical & Automation, Electrical Standard Products

L&T Business Park, TC-2, Tower B, 3rd Floor, Gate No. 5,

Saki Vihar Road, Powai,

Mumbai - 400 072, INDIA. www.Lntebg.com



COMPANY
INFORMATION

Ver.4.0