

MO 140/ MO 185/ MO 225 MO 250/ MO 300

CONVENTIONAL COIL

CS95000 MO 140
CS95001 MO 185
CS95002 MO 225
CS94441 MO 250
CS94440 MO 300

ELECTRONIC COIL

CS95042 MO 140
CS95047 MO 185
CS95052 MO 225
CS94456 MO 250
CS94464 MO 300

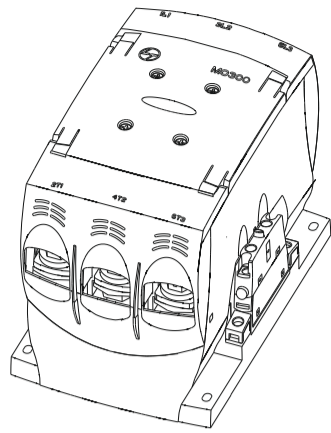

The manufacturer assumes no responsibility for injuries, losses, damages to human beings and/or equipments due to inappropriate application of instructions, provided herein.



Disconnect the power and isolate the product before proceeding with any work on this equipment.
Always use an appropriate voltage detection device to confirm the absence of voltage.
Installation to be done by qualified personal only.
Hazards of electric shock and fire.



Packaging material (carton & padding) can be recycled. Poly bags can be recycled separately.

OVERALL DIMENSIONS

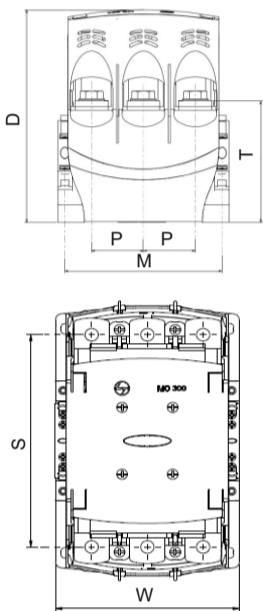

LABEL	MO 140/MO 185/MO 225	MO 250 / MO 300
W	120	145
D	170	190
H	197.5	225
M	108	133
T	96.5	108.5
S	156	177.6
P	36.5	44

ALL DIMENSIONS ARE IN MM.



DRILLING PLAN

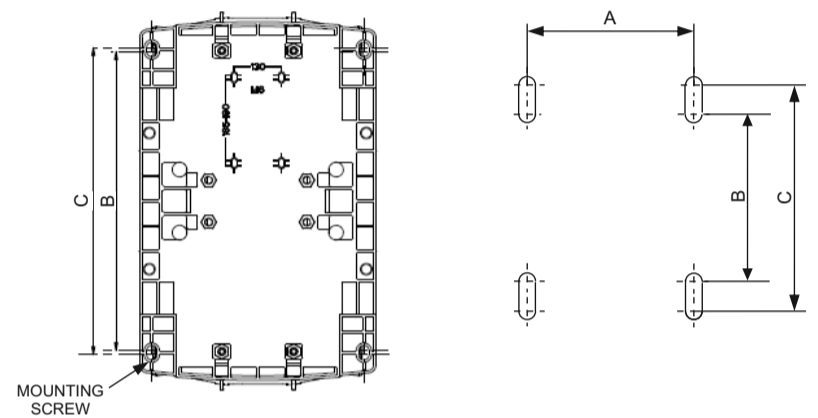

RATING	MOUNTING SCREW	DIM. A	DIM. B	DIM. C
MO 140/185/225	M5	105	157	163
MO 250/300	M6	130	185	190

ALL DIMENSIONS ARE IN MM.



SPARE ACCESSORIES

SPARE DESCRIPTION	CATALOGUE NO.
MO 140/128/225	
Spare Coil(Conventional) - MO 140/128/225	CS90365*
Spare Coil(Electronic Coil) - MO 140/128/225	CS90855*
Spare Contact Kit - MO 140	CS903570000
Spare Contact Kit - MO 185	CS903580000
Spare Contact Kit - MO 225	CS903590000
Spare Link Kit - MO 140/128/225	CS909390000
MO 250/300	
Spare Coil(Conventional) - MO 250/300	CS94442*
Spare Coil(Electronic Coil) - MO 250/300	CS90738*
Spare Contact Kit - MO 250	CS944440000
Spare Contact Kit - MO 300	CS944430000
Spare Link Kit - MO MO 250/300	CS909400000

*ADD 4 DIGIT COIL VOLTAGE SUFFIX

ACCESSORIES DESCRIPTION	CATALOGUE NO.	TERMINAL MARKINGS
Auxiliary Contact Blocks		
Side 1NO+1NC (First Left)	CS950330000	13-14, 21-22
Side 1NO+1NC (First Right)	CS950340000	33-34, 41-42
Side 1NO+1NC (Second Left)	CS950350000	53-54, 61-62
Side 1NO+1NC (Second Right)	CS950360000	73-74, 81-82



SIDE ADD-ON FITMENT

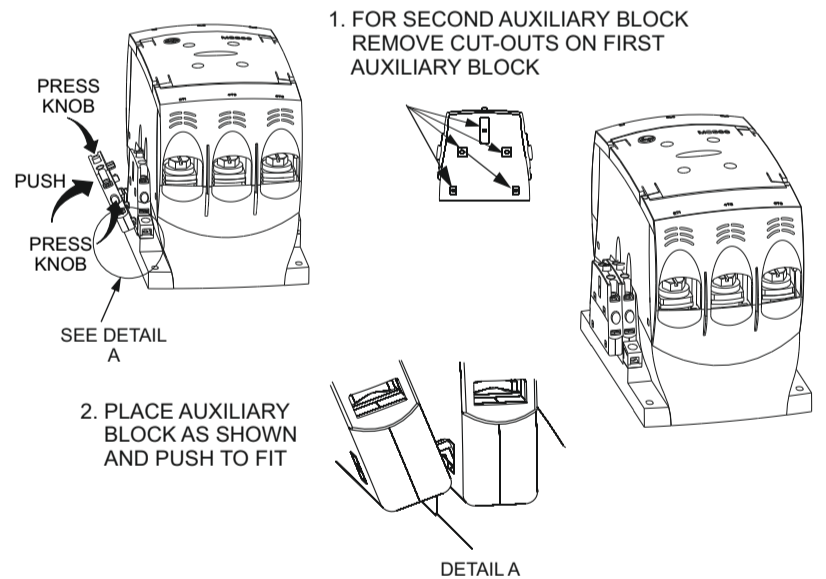

COIL REPLACEMENT

1. PRESS THE CLICK FIT ON BOTH SIDES OF SIDE COVER. REMOVE SIDE COVER.
2. REMOVE SIDE ADD ON

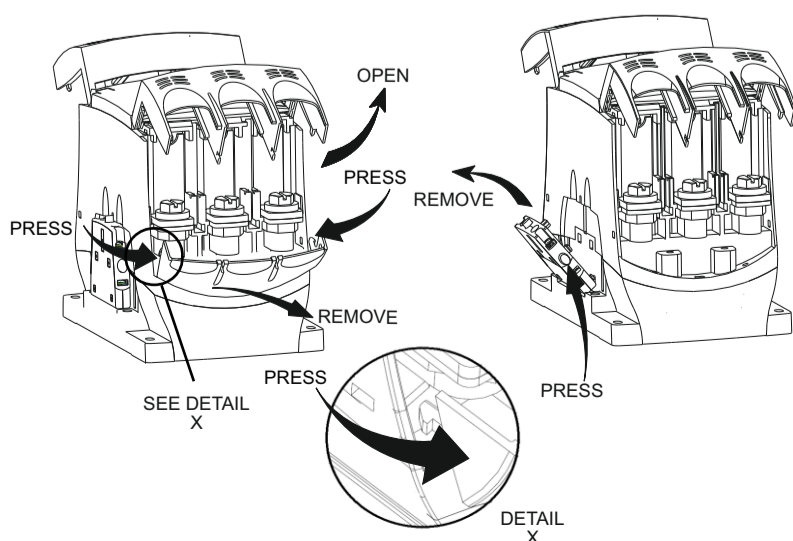

COIL REPLACEMENT (CONVENTIONAL)

3. UNSCREW HOUSING FIXING SCREWS
4. PULL UP THE COIL ASSEMBLY ALONG WITH THE COIL TERMINALS FROM THE REAR HOUSING AS SHOWN BELOW. REMOVE AND REPLACE THE COIL ASSEMBLY

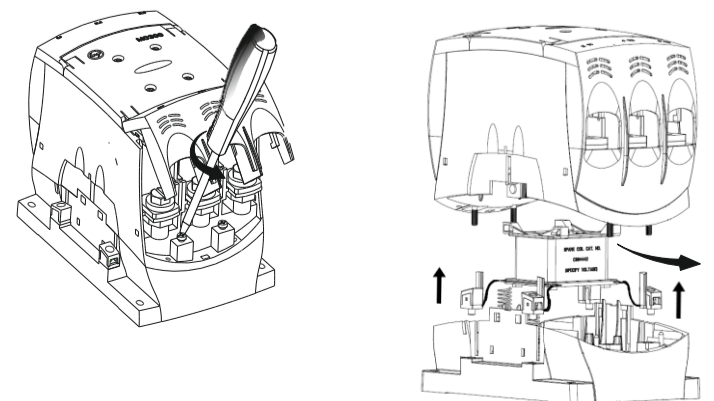

COIL REPLACEMENT (CONVENTIONAL)

- LOCATE THE RETURN SPRINGS IN THE REAR HOUSING AS SHOWN BELOW
- ENSURE THAT THE RETURN SPRINGS ARE LOCATED BETWEEN THE GUIDES IN FRONT AND REAR HOUSING ASSEMBLY AS SHOWN BELOW

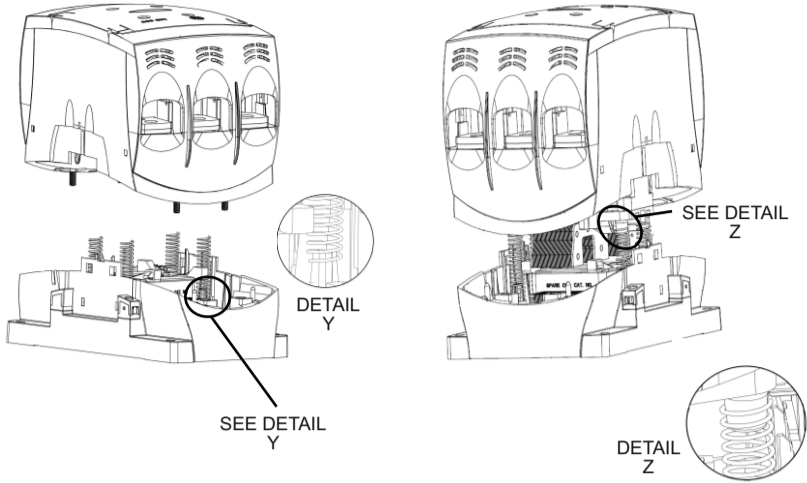

PRODUCT MAINTENANCE

COIL REPLACEMENT (ELECTRONIC COIL)

- REMOVE SIDE COVER & SIDE ADD-ON. REFER PAGE 7. UNSCREW HOUSING FIXING SCREWS
- PULL UP THE COIL ASSEMBLY ALONG WITH ELECTRONIC CARD AND COIL TERMINALS FROM THE REAR HOUSING AS SHOWN BELOW. REMOVE & REPLACE THE COIL AS SHOWN. REFER STEPS 5 & 6 OF PAGE 9 TO ENSURE RETURN SPRING LOCATION

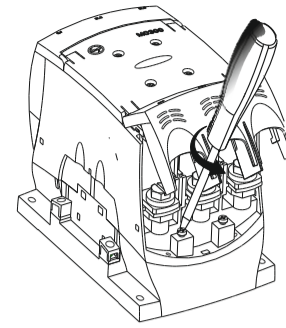

- CONNECT THE ELECTRONIC CARD TO THE COIL TERMINAL WITH THE HELP OF SNAP-ON LUGS AS SHOWN

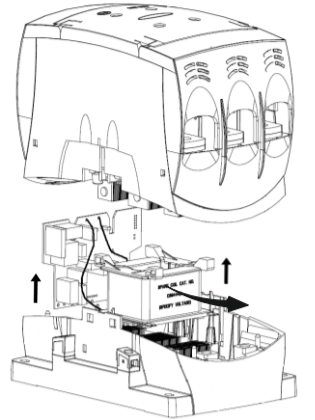

PRODUCT MAINTENANCE

COIL TERMINATION

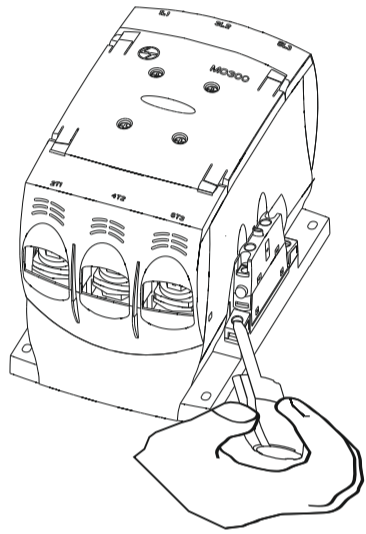

PRODUCT MAINTENANCE

MOVING CONTACT INSPECTION

- UNSCREW & REMOVE TOP COVER. REMOVE SIDE COVER.
- REMOVE ARC CHUTE ASSEMBLY

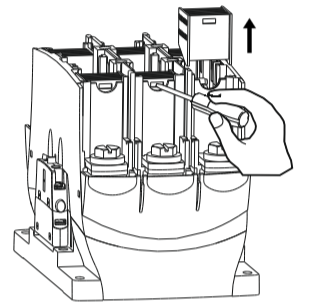
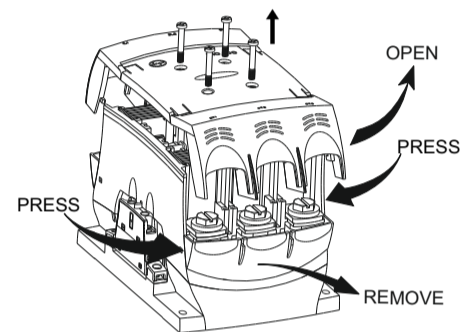

PRODUCT MAINTENANCE

MOVING CONTACT INSPECTION

- FOR MO 250/ MO 300 ENSURE THAT THE DAMPING RUBBER IS RETAINED DAMPING FRONT HOUSING SLOTS.
- LIFT THE STRAP PIN WITH PLIER & SLIDE THE MOVING CONTACT TO REMOVE.

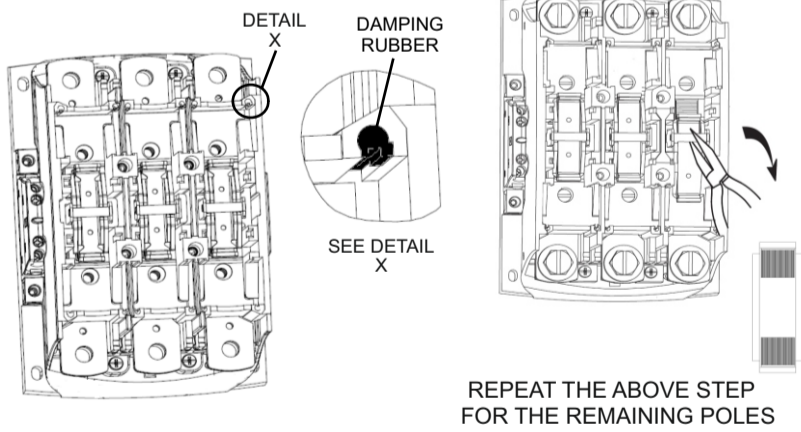

REPEAT THE ABOVE STEP FOR THE REMAINING POLES



PRODUCT MAINTENANCE

FIXED CONTACT REPLACEMENT

- UNSCREW & REMOVE TOP COVER. REMOVE SIDE COVER.
- REMOVE ARC CHUTE ASSEMBLY

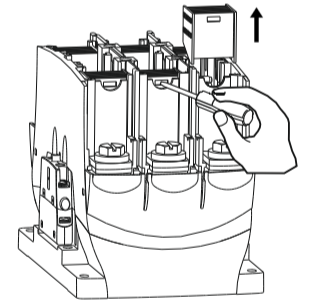
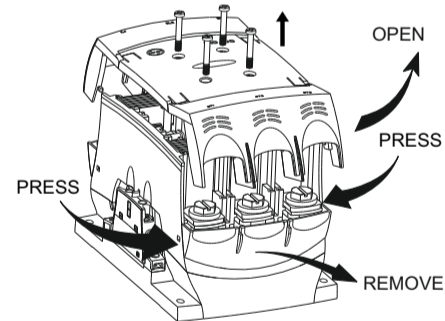

PRODUCT MAINTENANCE

FIXED CONTACT INSPECTION

- FOR MO 250/ MO 300 ENSURE THAT THE DAMPING RUBBER IS RETAINED DAMPING FRONT HOUSING SLOTS.
- INSPECT THE FIXED CONTACTS AS SHOWN BELOW.

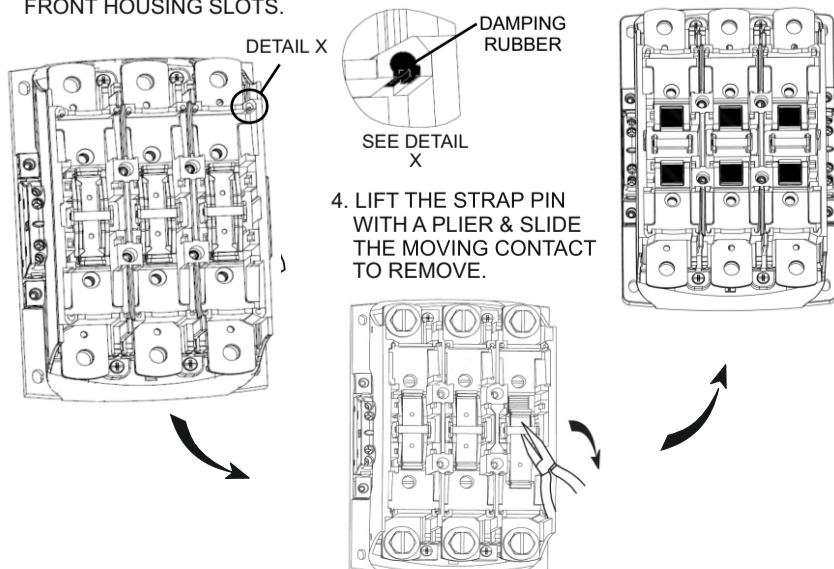

- LIFT THE STRAP PIN WITH A PLIER & SLIDE THE MOVING CONTACT TO REMOVE.



PRODUCT MAINTENANCE

MOVING CONTACT INSPECTION

- UNSCREW & REMOVE TOP COVER. REMOVE SIDE COVER.
- REMOVE ARC CHUTE ASSEMBLY

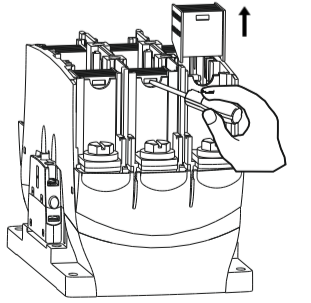
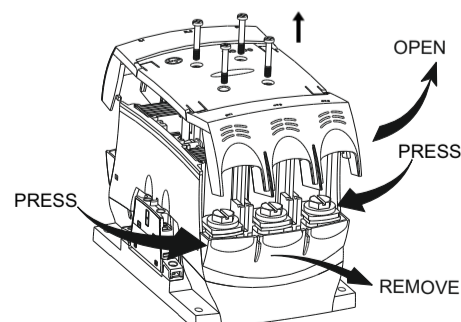

PRODUCT MAINTENANCE

FIXED CONTACT REPLACEMENT

3. FOR MO 250/ MO 300
ENSURE THAT THE DAMPING RUBBER IS RETAINED DAMPING FRONT HOUSING SLOTS.

4. LIFT THE STRAP PIN WITH PLIER & SLIDE THE MOVING CONTACT TO REMOVE. REPLACE IT WITH THE NEW MOVING CONTACT.

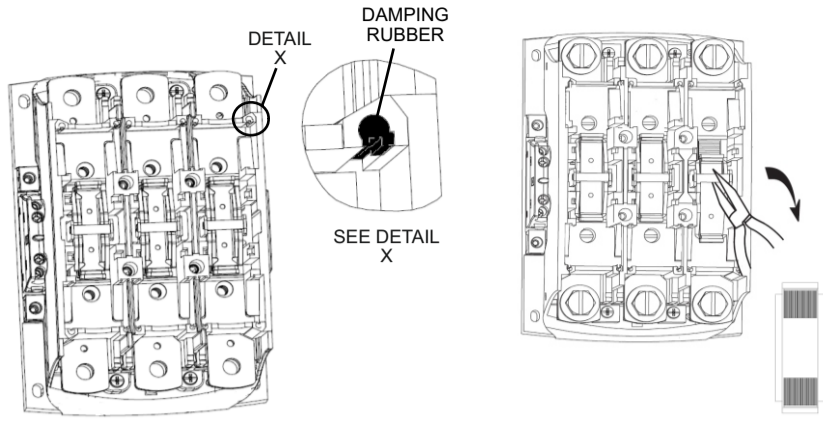

REPEAT THE ABOVE STEP FOR THE REMAINING POLES



PRODUCT MAINTENANCE

FIXED CONTACT REPLACEMENT

1. REMOVE THE MOVING CONTACTS, REFER PAGE 15-16 (MOVING CONTACT REPLACEMENT). UNSCREW THE FIXED CONTACT FROM THE TERMINAL.

2. REMOVE & REPLACE THE FIXED CONTACT ASSEMBLIES. ENSURE LOCATION & SEQUENCE OF PLAIN WASHER & SPRING WASHER AS SHOWN BELOW

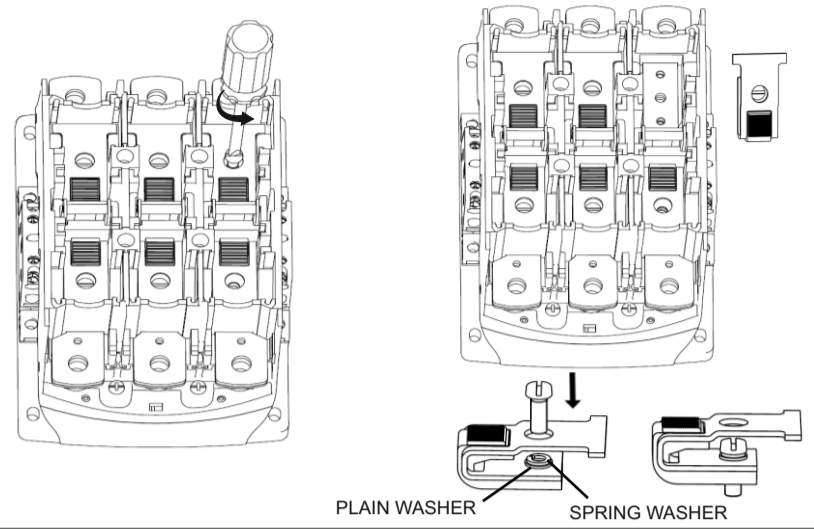

PRODUCT MAINTENANCE

ASSEMBLY OF ARC CHUTE

3. FOR MO 250/ MO 300
ENSURE THAT THE DAMPING RUBBER IS RETAINED DAMPING FRONT HOUSING SLOTS.

3. SCREW THE TOP COVER. ASSEMBLE THE SIDE COVER

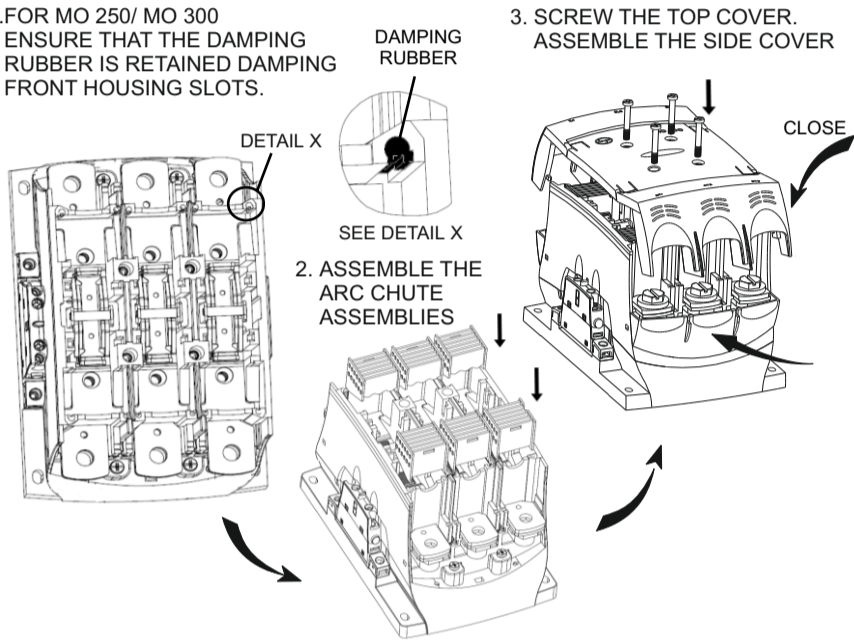

PRODUCT MAINTENANCE



DISCLAIMER NOTES

"This literature gives information to user about product installation, operation maintenance and disposal. This information is not exhaustive and should customer require further information, in specific cases, customer may contact customer interaction cell."

"The manufacturer assumes no responsibility for injuries, losses, damages to human beings and/or equipments due to inappropriate application of instructions, provided herein."

"Product development is a continuous process. The information given in this literature is subject to change. For latest information the customer may contact customer interaction cell"

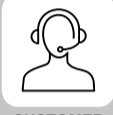

CUSTOMER CARE

CUSTOMER INTERACTION CELL (CIC)

BSNL / MTNL (Toll-Free): 1800 233 5858
RELIANCE (Toll-Free): 1800 200 5858
Telephone: 022 6774 5858
email: cic@LNTEBG.com
website: www.LNTEBG.com



COMPANY INFORMATION

SP002304

L&T SWITCHGEAR
SAFE & SURE

**L&T Electrical & Automation,
Electrical Standard Products,**

L&T Business Park, TC-2, Tower B, 3rd Floor,
Gate No.5, Saki Vihar Road, Powai,
Mumbai - 400 072, INDIA. www.Lntebg.com

VER. X.X

SPREADER LINK KIT WITH PHASE BARRIER

MO 140 / MO 185 / MO 225 / MO 250 / MO 300

CS91057 MO 140/185/225
CS90940 MO 140/300

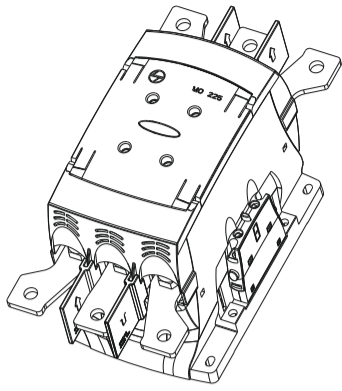

The manufacturer assumes no responsibility for injuries, losses, damages to human beings and/or equipments due to inappropriate application of instructions, provided herein.



Disconnect the power and isolate the product before proceeding with any work on this equipment.
Always use an appropriate voltage detection device to confirm the absence of voltage.
Installation to be done by qualified personal only.
Hazards of electric shock and fire.



Packaging material (carton & padding) can be recycled.
Poly bags can be recycled separately.

OVERALL DIMENSIONS

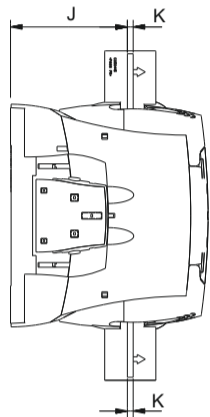
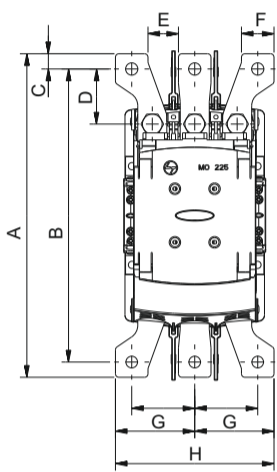

LABEL	MO 250/185/225
A	276
B	250
C	13
D	47
E	26.2
F	28
G	54.2
H	136.4
J	110.5
K	5

ALL DIMENSIONS ARE IN MM.



PRODUCT INSTALLATION

OVERALL DIMENSIONS

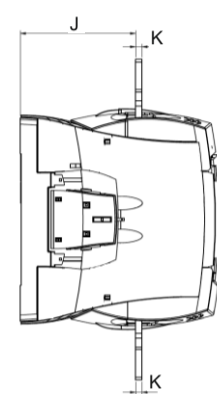
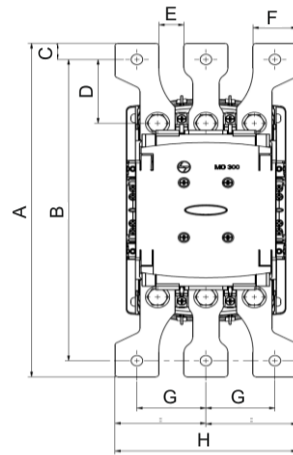

LABEL	MO 250 / MO 300
A	341
B	308
C	17
D	65
E	23
F	40
G	63
H	166
J	108.5
K	6

ALL DIMENSIONS ARE IN MM.



PRODUCT INSTALLATION

INSTALLATION OF SPREADER TERMINALS AND PHASE BARRIERS

1. OPEN THE TOP COVER.
2. UNSCREW THE BOLT FROM THE TERMINAL WITH THE HELP OF RATCHET AS SHOWN IN THE FIGURE BELOW AT ALL SIX LOCATIONS.

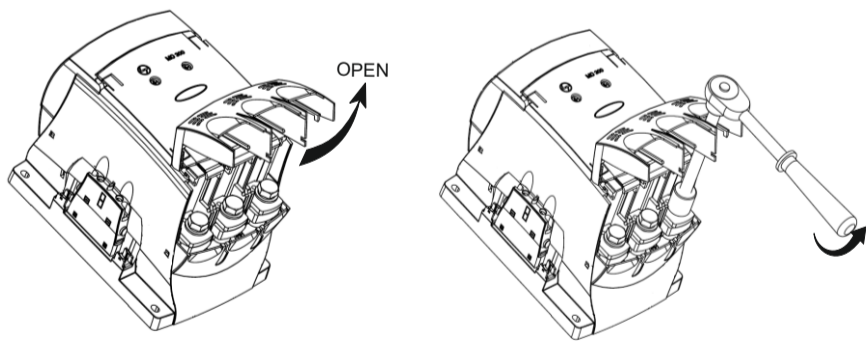

PRODUCT INSTALLATION

INSTALLATION OF SPREADER TERMINALS AND PHASE BARRIERS

3. ASSEMBLE THE SPREADER LINKS IN THE ORDER AND TIGHTEN THESE TERMINALS WITH M10 BOLTS USING THE RATCHET AS SHOWN BELOW
5. CLOSE THE SIDE COVER SHROUD IN THE DIRECTION AS SHOWN BELOW

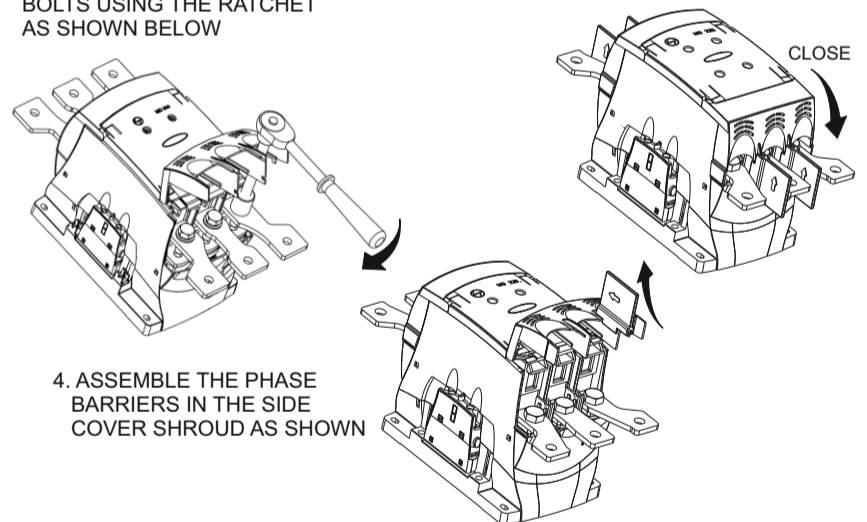

PRODUCT INSTALLATION

INSTALLATION OF SPREADER TERMINALS

1. OPEN THE TOP COVER.
2. UNSCREW THE BOLT FROM THE TERMINAL WITH THE HELP OF RATCHET AS SHOWN IN THE FIGURE BELOW AT ALL SIX LOCATIONS.

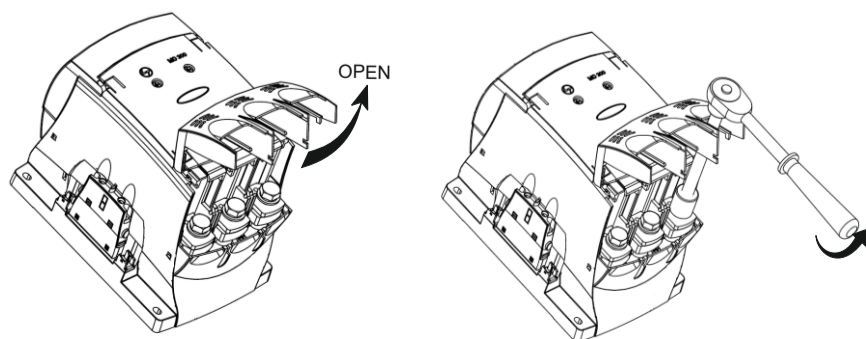

PRODUCT INSTALLATION

INSTALLATION OF SPREADER TERMINALS

3. ASSEMBLY THE SPREADER LINKS IN THE ORDER AS SHOWN BELOW
5. CLOSE THE SIDE COVER SHROUD IN THE DIRECTION AS SHOWN BELOW.

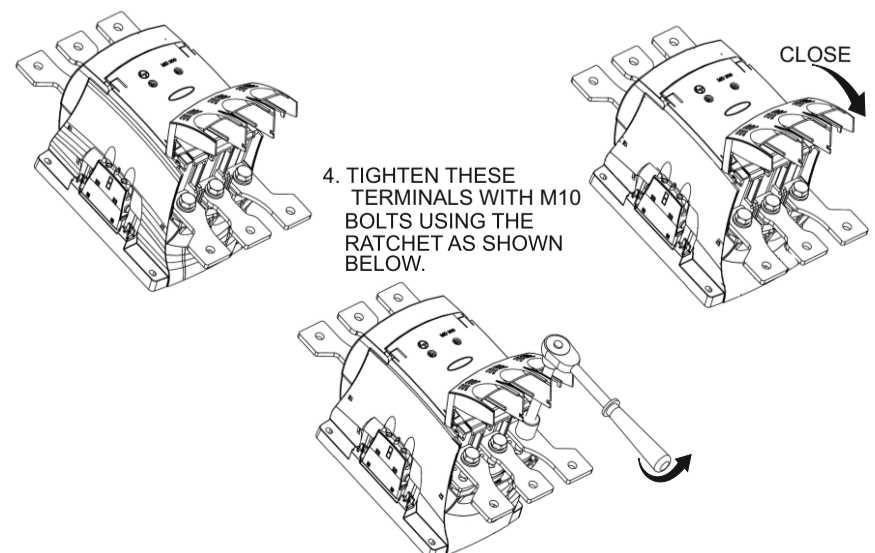

PRODUCT INSTALLATION



**DISCLAIMER
NOTES**

"This literature gives information to user about product installation, operation maintenance and disposal. This information is not exhaustive and should customer require further information, in specific cases, customer may contact customer interaction cell."

"The manufacturer assumes no responsibility for injuries, losses, damages to human beings and/or equipments due to inappropriate application of instructions, provided herein."

"Product development is a continuous process. The information given in this literature is subject to change. For latest information the customer may contact customer interaction cell"



**CUSTOMER
CARE**

CUSTOMER INTERACTION CELL (CIC)

BSNL / MTNL (Toll-Free): 1800 233 5858
RELIANCE (Toll-Free): 1800 200 5858
Telephone: 022 6774 5858
email: cic@LNTEBG.com
website: www.LNTEBG.com

SP02743



**L&T Electrical & Automation,
Electrical Standard Products,**

L&T Business Park, TC-2, Tower B, 3rd Floor,
Gate No.5, Saki Vihar Road, Powai,
Mumbai - 400 072, INDIA. www.Lntebg.com



**COMPANY
INFORMATION**

VER. 2.0